

电机规格书

电机型号(Model):

JL-12ZN20-43-06450

样品单号(Sample Code):

日期(Date):

额定电压 VDC
Rated Voltage

6

使用环境温度范围 °C
Operating Condition
Temperature Range

-10~+60

空载转速 rpm
No-load speed

450±10%

空载电流 mA
Free-load Current

≤80

负载转矩 Kgf.cm
Rated Torque

0.05

负载转速 rpm
On-load speed

400±10%

负载电流 mA
Roted Current

≤180

堵转电流 mA
Stall Current

750(Ref)

堵转力矩 Kgf.cm
Stall Torque

≥0.4

旋向 CW/CCW
Direction

CW

噪音 dBA
Noise (L=300mm)

65 (Max)

轴向间隙 mm
Axial gap

0.02~0.3

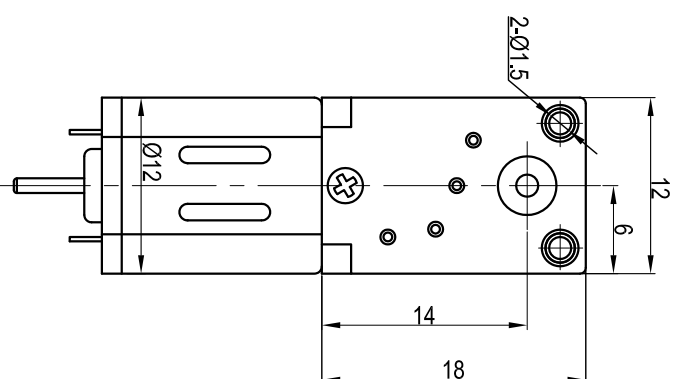
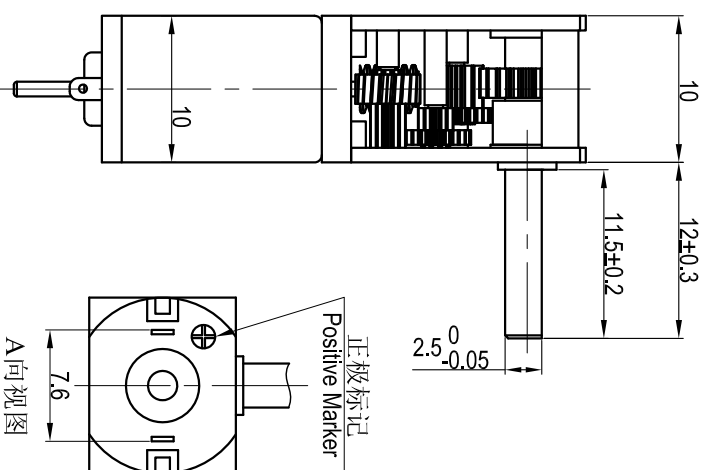
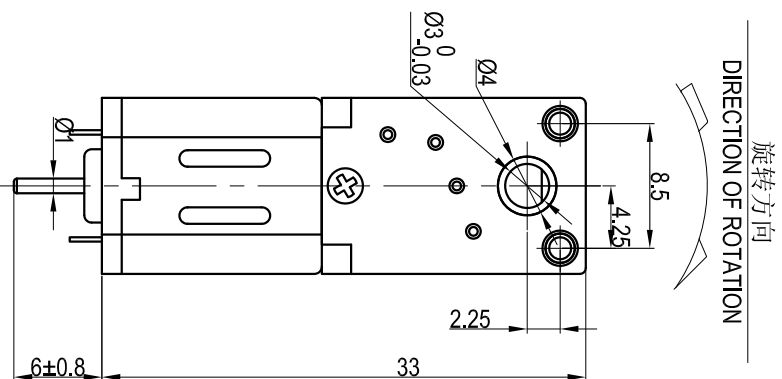

电机规格书

外形图
outside drawing

客户确认
Confirmation Approved

制订:
Formulate

周晓龙

Unit

mm

Size

A4

审核:
Audit

Phase marker

version

A0

Scale

2:1

批准:
Approved

批准:

Phase marker

S

Page

1

2

3

4

5

6

7

8

F

E

D

C

B

A